

Enquiries: 08 9184 4444
Our Ref: OI.0000

Shire of Ashburton
Administration Centre
246 Poinciana Street
PO Box 567, Tom Price, WA, 6751
E soa@ashburton.wa.gov.au
T (08) 9188 4444
F (08) 9189 2252

ashburton.wa.gov.au

ABN 45 503 070 070

17 July 2017

NOTICE OF INTENTION TO CARRY OUT ROAD CLOSURES

Dear Resident

The Shire of Ashburton is conducting road and drainage improvement works on Stadium Road, Tom Price. The works will require some road closures as stated in previous communications.

From the **21th of July** to the **27th of July inclusive**, asphalt works will commence on areas of Stadium Road.

On the **21st of July** at the western end of Stadium Road, the installation of traffic management will occur from 2pm and fencing will be installed from 5pm onwards. **From the 22nd until the 25th** this fenced area will be asphalted. A map of this area and the traffic management that will support its closure is attached.

From the **25th to the 27th** other areas of asphalt will only require minor traffic control.

We apologise for any inconvenience these works may cause. Your co-operation is appreciated.



If you require any further information regarding these works please contact the Shire's representative, Shane Godfrey on 08 9188 4459.

Yours Sincerely



Shane Godfrey
Technical Officer



	1:832
	<p>The Shire of Ashburton does not warrant the accuracy of information in this publication and any person using or relying upon such information does so on the basis that DNS shall bear no responsibility or liability whatsoever for any errors, faults, defects or omissions in the information.</p>
	

GENERAL NOTES

1. THIS DRAWING IS TO BE READ IN CONJUNCTION WITH AS1742.3 & MRWA COP OCTOBER 2015.
2. ALL TRAFFIC CONTROL DIAGRAMS TO BE READ CONJUNCTION WITH THE TRAFFIC MANAGEMENT DOCUMENT
3. NON-APPLICABLE EXISTING SIGNAGE SHALL BE COVERED EG. SPEED SIGNS DUE TO THE TEMPORARY SPEED ZONE.
4. ALL SIGNAGE DISTANCE SHALL COMPLY WITH AS1742.3 & MRWA COP OCTOBER 2015.
5. IN ACCORDANCE WITH AS1742.3 ACCREDITED TRAFFIC CONTROLLERS TO ASSIST PEDESTRIANS WITH MOVEMENT THROUGH & AROUND THE WORKSITE.
6. SIGNAGE SHALL BE PLACED ON THE SIDE OF THE ROAD ADJACENT TO THE TRAFFIC FLOW, MEDIUM ISLANDS.
7. AS WORK PROGRESSES THE TRAFFIC MANAGEMENT WILL BE DISMANTLED & ADJUSTED TO SUIT THE IMMEDIATE SITE CONDITIONS.

RECOMMENDED TAPER LENGTH

APPROXIMATE SPEED OF TRAFFIC KMH	TRAFFIC CONTROL AT BEGINNING OF TAPER	LATERAL SHIFT OF TAPER	MERGE TAPER
45 OR LESS	15	0	15
46-55	15	15	30
56-65	30	30	60
66-75	N/A	70	115
76-85	N/A	80	130
86-95	N/A	90	145
96-105	N/A	100	160
> 105	N/A	110	180

DIMENSION "D"

SPEED OF TRAFFIC KMH	DIMENSION "D" M
45 OR LESS	15M
46-55	15M
56-65	45M
GREATER THAN 65KMH	EQUAL TO SPEED POSTED

TOLERANCES

POSITIONING OF SIGNS MINIMUM 10% LESS THAN THE DISTANCE OR LENGTHS GIVEN
 MAXIMUM 25% MORE THAN THE DISTANCE OR LENGTHS GIVEN
 SPACING OF DELIMITING DEVICES MAXIMUM 10% MORE THAN THE SPACES GIVEN
 NO MINIMUM

LANE WIDTHS

THE MIN LANE WIDTH TO BE PROVIDED THROUGH OR PAST THE WORKSITE SHALL BE 3.0M AT TRAFFIC SPEEDS UP TO 60KMH & 3.2 AT 60KMH. A WIDER LANE WIDTH IS REQUIRED AT CURVES.

www.invarion.com

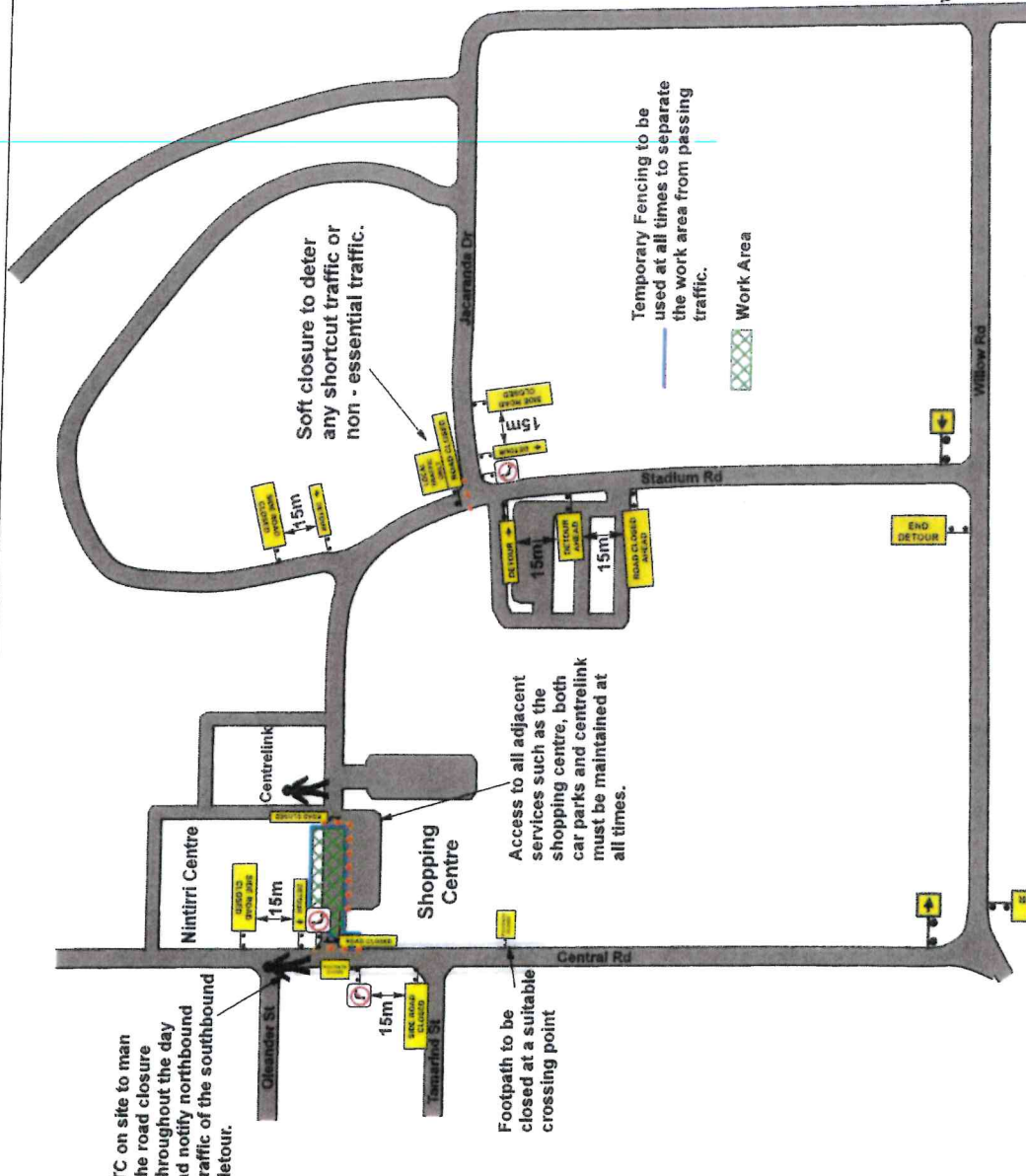

TCD No.
HS 16 - 01

DATE:	DRAWN BY:	ACCREDITATION:	SIGNATURE:
08/02/21	ANDREW SMITH	14-03627-01	
POSTED SPEED:	DESIGNED BY:	ACCREDITATION:	SIGNATURE:
40KMH	ANDREW SMITH	14-03627-01	
POSTED SPEED:	CHECKED BY:	ACCREDITATION:	SIGNATURE:
40KMH	JONAS SMITH	14-03628-01	



TEMPORARY SPEEDS

40KMH WITHIN 15M OF PLANT OPERATING

40KMH WITHIN 15M OF PLANT OPERATING

40KMH WITHIN 15M OF PLANT OPERATING

40KMH WITHIN 15M OF PLANT OPERATING

CLIENT:
Formstruct

TITLE:
Stadium Road Drainage Works

